

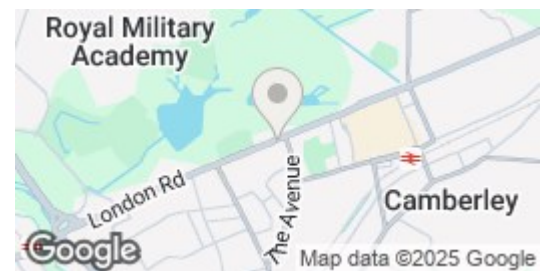

Nym Close | | Camberley | GU15 3HG

£1,800 PCM

*Waterfords*   
Residential Sales & Lettings

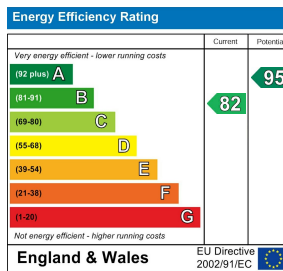
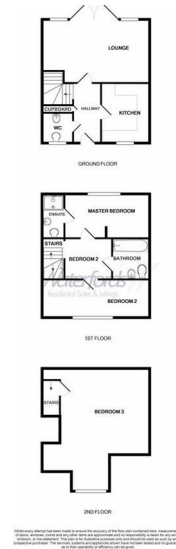

## Description

Welcome to this charming property located Nym Close, Camberley. This delightful mid-terrace house boasts a modern finish and is perfect for a family looking for a comfortable and stylish home.

Inside, you are greeted by a spacious reception room, ideal for entertaining guests or simply relaxing with your loved ones. The property features three generously sized bedrooms, offering plenty of space for the whole family to enjoy.

With two bathrooms, mornings will be a breeze in this household, ensuring no one is left waiting in line. The high-spec townhouse style adds a touch of elegance to the property.

## Key features

- Three double bedrooms
- Modern Finish Throughout
- Private rear garden
- EPC B
- minimum 12 month let With a 6 Mont Break Clause
- En-suite to master and further family bathroom
- Allocated parking space
- Available January 2025 on an unfurnished basis
- Council Tax Band D



35 Plough Road  
Hampshire  
GU46 7UW  
01276 903006

surreylettings@waterfords.co.uk  
<https://www.waterfords.co.uk/>